

Adam,Rouilly

SIMULATORS, ANATOMICAL MODELS AND CHARTS FOR CLINICAL SKILLS AND TRAINING



AR321/AR321-B

Rectal Examination Model



Instruction Manual

Thank you for purchasing this AR321/AR321-B Rectal Examination Model.

The model has been developed with the advice and guidance of expert practitioners from the RCN Continence Care Team. It simulates a patient lying in the left lateral position with the top leg slightly flexed. The buttocks, being slightly apart, allow a clear view of the anus and perineal skin for observation purposes.

Nurses, both in hospital and community settings, are expected to provide help and advice to a wide range of patients whom at some time during their care experience difficulties with normal bowel function.

Please read this instruction manual carefully and retain it for future reference.

Skills

- This model has been developed for nurses performing rectal examination to assess the amount and consistency of stools in the rectum
- Model is designed to be placed on its left side for examination in the left lateral position
- Administering solid rectal medication.
(This model is not suitable for liquid medication)

Features

- Buttocks with rectum for digital assessment of different types of stools
- Interchangeable stools can be easily placed in the rectum
- Representation of nine types of stool ranging from soft to hard
- Thirteen laminated photographs of differing bowel conditions are also included for visual reference.

Safety and Precautions



The material used in the anal canal is very delicate. KY Jelly (supplied) and examination gloves must always be used during use. Failure to do so may result in severe damage to the anal canal in the model.



Stools must be lubricated with KY Jelly before use.



Use of other lubricants may damage the model.
It is imperative that ONLY KY Jelly is used with this simulator.
We accept no responsibility for models damaged to due incorrect use.



Please treat the trainer with the same care you would a patient.

Contents

Parts and Configuration	4
- Simulated Stools	4
- Supplied with	5
Preparing the Model For Use	
- Inserting and Lubricating the Anal Canal	6
- Using Simulated Stools 1-6 + 8	6
- Using Simulated Stools 7 + 10	8
During Use	
- Digital Rectal Examination	10
- Solid Rectal Medication	10
After Use	
- Removal of Stool Holder & Anal Canal	10
- Cleaning the Model	10

Parts and Configuration

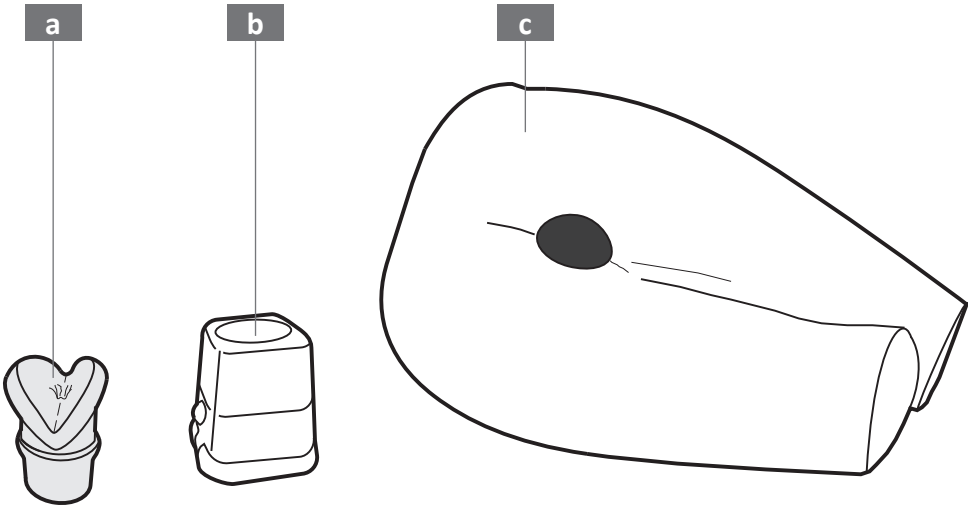

Simulated Stools (1 - 7 Based on the Bristol Stool Scale)

- | | | | | | |
|----------|--|---|-----------|--|---|
| 1 | | Separate hard lumps, like nuts (hard to pass) | 6 | | Fluffy pieces with ragged edges, a mushy stool |
| 2 | | Sausage shaped, but lumpy | 7 | | Watery, no solid pieces (balloon to be filled with 15ml of water) |
| 3 | | Like a sausage but with cracks on the surface | 8 | | Impacted stool |
| 4 | | Like a sausage or snake, smooth and soft | 9 | | Insert to retain numbers 7 & 10 |
| 5 | | Soft blobs with clear cut edges (passed easily) | 10 | | Stool samples for manual evacuation |

a **SPAR321/C** Anus and Anal Canal

b Stool Holder

c Main body

Supplied With

SPAR321/A Set of 9 Stools

SPAR321/B Anal Sphincter Conditions (Set of 13 Photographs in Folder)

SPAR321/D KY Jelly



If you require replacement parts please contact our Sales Department, quoting codes where applicable.

Preparation for Use

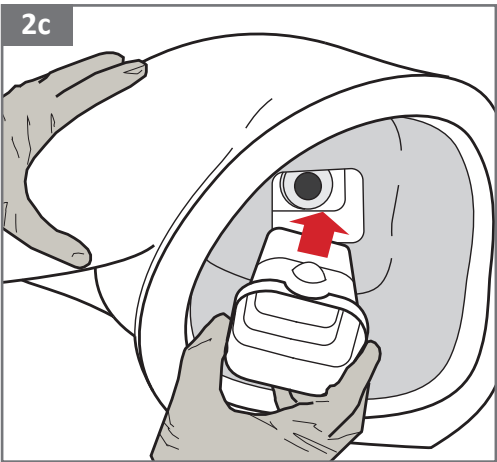
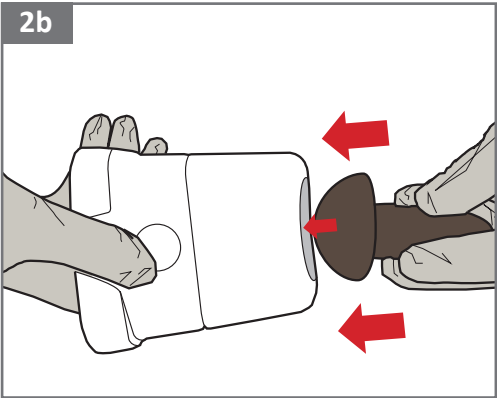
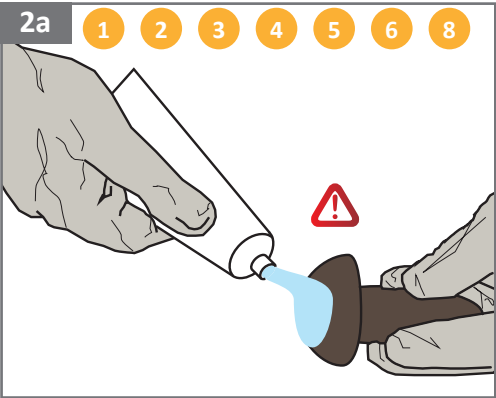
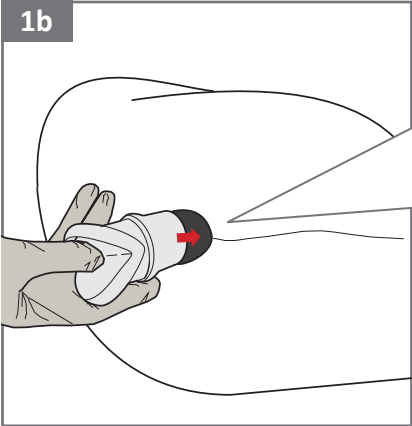

Lubricate and Insert Anal Canal into Main Body

Ensure the work area is clean and dry.

1a

Lubricate the anal canal using KY Jelly.



The anal canal must be lubricated with KY Jelly before use.

1b

Insert the anal canal into the channel in the main body of the model, so that it sits flush with the body as shown.

Using Simulated Stools 1 - 6 + 8

2a

Lubricate the selected stool using KY Jelly.



Stools must always be lubricated before use. Use only KY Jelly to lubricate stools - other lubricants may damage the model.

2b

Insert the stool into the stool holder by positioning the round end of the stool into the round indent in the stool holder.

2c

Insert the stool holder into the channel inside the model, pushing until a “click” confirms that it is locked into position.

Preparation for Use

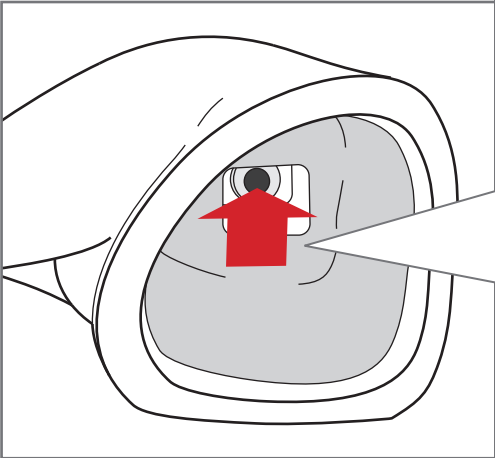

3a



3b

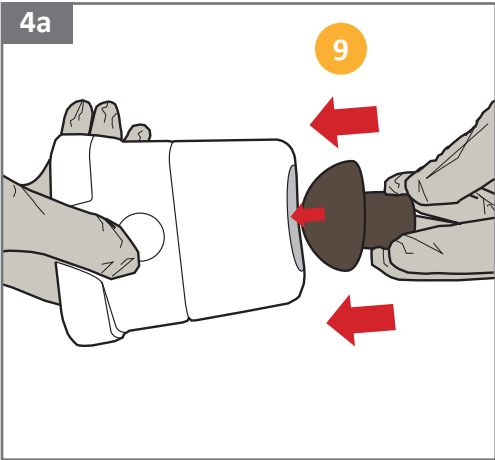

4b

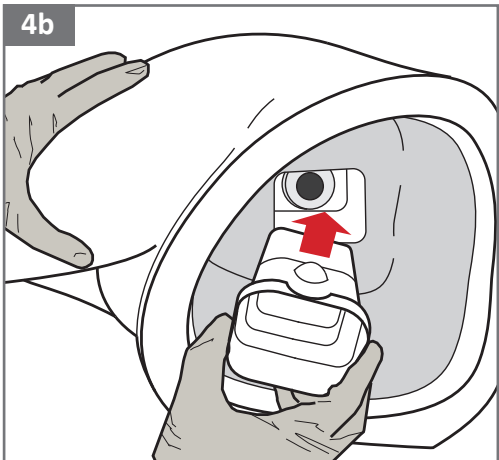

Using Simulated Stools 7 + 10

3a

Stool 7 : Fill balloon with approximately 15 ml of water. Fasten balloon and place directly into anal canal from inside model. Proceed to **Step 4a**.

3b

Stool 10 : Place lubricated stools directly into anal canal from inside model. Proceed to **Step 4a**.

4a

Place Stool Retainer Insert **9** into the stool holder and lubricate.

4b

Insert the stool holder into the channel inside the model, pushing until a “click” confirms that it is locked into position.

During Use

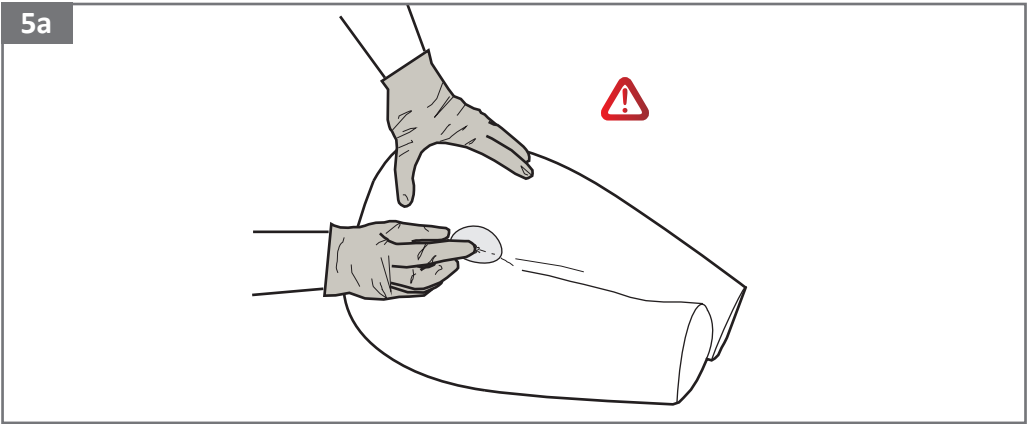

After Use

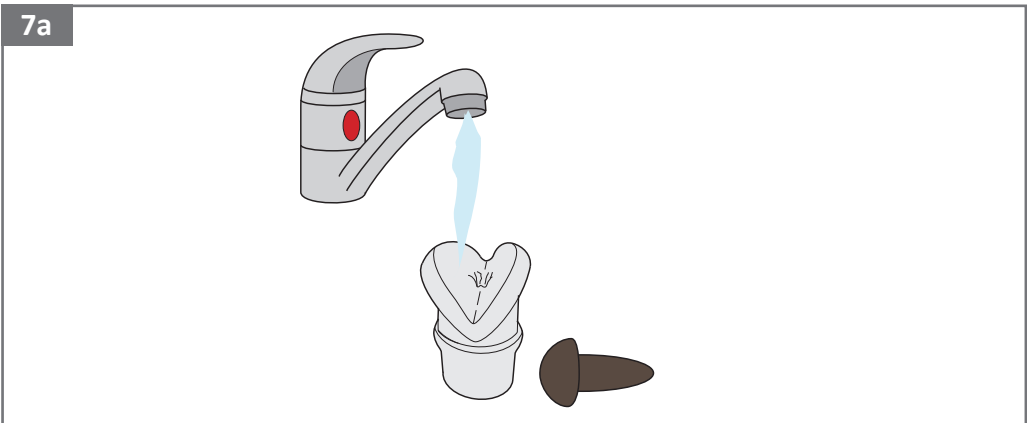
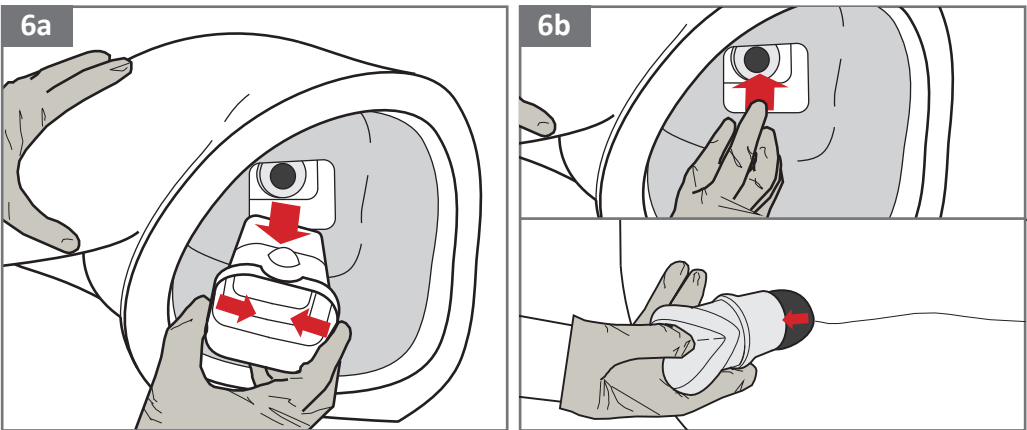

Digital Rectal Examination

5a

During use, insert finger into rectum carefully to assess stool type.



The anal canal material is very delicate and unless KY Jelly and examination gloves are used it will become damaged. It is imperative that ONLY KY Jelly is used with this simulator. Other lubricants may damage the model. We accept no responsibility for models damaged due to incorrect use.

Solid Rectal Medication

The model may also accept solid rectal medication



This model is not suitable for liquid medication.

Remove the Stool Holder and Anal Canal

6a

Remove the stool holder by exerting pressure on the indented lip and pull the stool holder out of the model.

6b

Remove the anal canal by gently pushing it from inside the model whilst carefully easing it from the outside.

Wash Parts After the Training Session

7a

To prolong the life of this simulator, it is essential that the anal canal and stools are removed, and washed in warm water after each training session.

Long Term Maintenance

The outside of the model may be washed with a soft cloth and mild soap solution.

Adam,Rouilly

Adam,Rouilly has over 93 year's experience in providing quality medical models and simulators.

Should you require any further information please contact our Sales Department who will be pleased to help with your enquiry.

Adam,Rouilly Limited
Castle Road
Eurolink Business Park
Sittingbourne
Kent
United Kingdom
ME10 3AG

T: +44(0)1795 471378
F: +44(0)1795 479787
E: sales@adam-rouilly.co.uk
www.adam-rouilly.co.uk